

Reach mast technology saves space

Maximum throughput with the lowest energy consumption

Generously designed operator workplace

Sensitive handling while driving and lifting

Assistance systems to adapt trucks to your specific application



ETV/ETM 318/320/325

Electric reach truck (1,800/2,000/2,500 kg)

Space-saving design, high performance, innovative technology and optimum ergonomic working conditions. These are the strengths of the Jungheinrich reach truck. Whether for handling pallets, operating in drive-through or drive-in racking. Whether for extremely narrow areas or low clearances. Whether for single shift or multishift applications: the 3 series reach truck is the perfect solution for every application.

The main advantages:

- Saving of space with narrow aisle widths from 2790 mm.
- Residual capacities of 1000 kg to 13 metres lift height.

- The very latest drive and control technology ensures greater productivity whilst at the same time reducing energy consumption.

The advanced ergonomics and technology increases productivity of the operators, thanks to:

- Outstanding visibility through the panoramic overhead guard both when in motion and when stacking pallets, thanks to the panoramic overhead guard.
- Automotive pedal configuration.
- Curve Control –automatic reductions of speed when cornering.

180° and 360° steering: Allows the operator to select between minimum turning radius and rapid change in travel direction. The steering wheel spinner knob is always positioned at the ergonomically optimum 9 o'clock position when driving in a straight line.

SOLO-PILOT control lever: For sensitive stacking, even at high lift heights.

The right configuration for your needs: An extensive catalogue of options with a wide variety of assistance systems and battery versions from 560 to 930 Ah ensures the truck can be adapted to suit any application

ETV/ETM 318/320/325

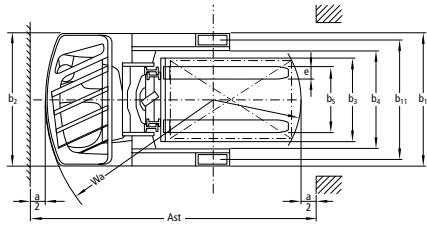
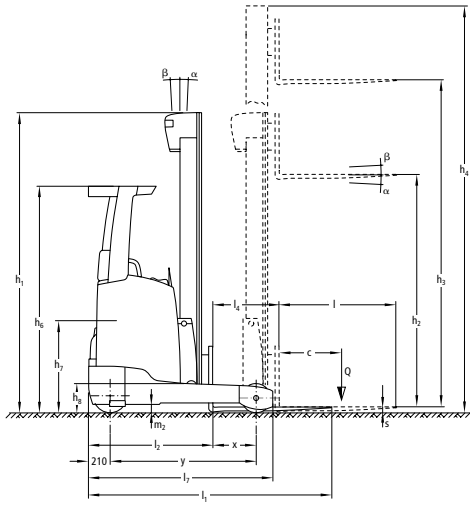

Capacity

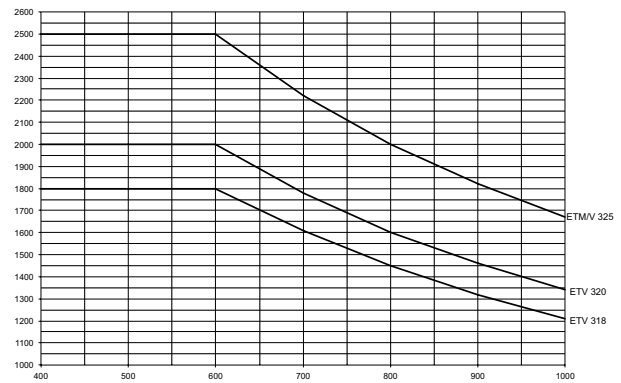

Load centre distance "c" in mm

Standard mast types ETV 318/ETV 320/ETM 325/ETV 325						
Designation	Lift h_3 (mm)	Closed mast height h_1 (mm)	Free lift h_2 (mm)	Extended mast height h_4 (mm)	Mast tilt forward / back a/β (°)	Tilt forks forward / back ¹⁾ a/β (°)
Triplex DZ	4250	2050	1320	4996	1/5	-
	4700	2200	1470	5446	1/5	-
	5000	2300	1570	5746	1/5	-
	5300	2400	1670	6046	1/5	-
	5600	2500	1770	6346	1/3	-
	5900	2600	1870	6646	0,5/2	-
	6200	2700	1970	6946	0,5/2	2/5
	6500	2800	2070	7246	0,5/2	2/5
	6800	2900	2170	7546	0,5/2	2/5
	7400	3100	2370	8146	0,5/1	2/5
	8000	3300	2570	8746	0,5/1	2/5
	8420	3440	2710	9166	0,5/1	2/5
	8720	3540	2810	9466	0,5/1	2/5
	9110	3670	2940	9856	0,5/1	2/5
	9620	3840	3110	10366	-	2/5
	9950	3950	3220	10696	-	2/5
	10220	4100	3370	10966	-	2/5
	10520	4200	3470	11266	-	2/5
	10700	4260	3530	11446	-	2/5
	10880	4320	3590	11626	-	2/5
	11120	4400	3670	11866	-	2/5
11510	4530	3800	12256	-	2/5	
12020 ²⁾	4700	3970	12766	-	2/5	
12530 ²⁾	4870	4140	13276	-	2/5	
12830 ²⁾	4970	4240	13576	-	2/5	
13000 ²⁾	5026	4296	13746	-	2/5	

¹⁾ Fork tilt for ETV series only

²⁾ Only ETV 320/325

Technical data in line with VDI 2198

		Jungheinrich					
		ETV 318	ETV 320	ETM 325	ETV 325		
Identification	1.1	Manufacturer (short form)					
	1.2	Model					
	1.3	Drive	Electrics				
	1.4	Manual, pedestrian, stand-on, seated, order picker operation	transverse seat				
	1.5	Load capacity/rated load	Q t	1.8	2	2.5	2.5
	1.6	Load centre distance	c mm	600			
	1.8	Load distance	x mm	364 ¹⁾	412 ¹⁾	389 ¹⁾	487 ¹⁾
	1.8.1	Load distance, mast reached forward	x ₁ mm	205	230	230	230
	1.9	Wheelbase	y mm	1460	1518	1673	1673
Weights	2.1.1	Net weight incl. battery (see row 6.5)	kg	3522	3650	3895	3700
	2.3	Axle load, w.o. load, front / rear	kg	2074 / 1448	1842 / 1228	2274 / 1621	2264 / 1436
	2.4	Axle loading forks forward with load at front / rear	kg	446 / 4876	560 / 4110	366 / 6029	602 / 5598
	2.5	Axle loading forks retracted with load at front / rear	kg	1805 / 3517	1681 / 2989	2057 / 4338	2032 / 4168
Wheels / chassis	3.1	Tyres	Vulkollan ®				
	3.2	Tyre size, at front	mm	Ø 343 x 114	Ø 343 x 114	Ø 343 x 140	Ø 343 x 140
	3.3	Tyre size, at rear	mm	Ø 285 x 100	Ø 355 x 106	Ø 355 x 135	Ø 355 x 135
	3.5	Wheels, number front/rear (x = driven wheels)	1x / 2				
3.7	Track width, rear	b ₁₁ mm	1136	1155	1034	1184	
Basic dimensions	4.1	Tilt of mast/fork carriage forward/backward	α/β °	1/5 ²⁾			
	4.2	Mast height (lowered)	h ₁ mm	2400			
	4.3	Free lift	h ₂ mm	1670			
	4.4	Lift	h ₃ mm	5300			
	4.5	Extended mast height	h ₄ mm	6046			
	4.7	Height of overhead guard	h ₆ mm	2190			
	4.8	Seat height/stand height	h ₇ mm	1057			
	4.10	height of support arms	h ₈ mm	285 ⁷⁾	355 ⁷⁾	355 ⁷⁾	355 ⁷⁾
	4.19	Overall length	l ₁ mm	2418	2459	2547	2547
	4.20	Length incl. back of forks	l ₂ mm	1306 ¹⁾	1316 ¹⁾	1494 ¹⁾	1396 ¹⁾
	4.21	Total width	b ₁ /b ₂ mm	1270 / 1270	1290 / 1270	1198 / 1120	1348 / 1270
	4.22	Fork dimensions	s/e/l mm	40 / 120 / 1150	50 / 140 / 1150	50 / 140 / 1150	50 / 140 / 1150
	4.23	Fork carriage ISO 2328, class/type A, B	2B				
	4.24	Fork carriage width	b ₃ mm	830			
	4.25	Width over forks	b ₅ mm	335 / 730	356 / 750	356 / 580	356 / 750
	4.26	Width between support arms/loading surfaces	b ₄ mm	940	940	790	940
	4.28	mast reach	l ₄ mm	569 ¹⁾	624 ¹⁾	703 ¹⁾	736 ¹⁾
4.3.2	Floor clearance centre wheelbase	m ₂ mm	80	95	95	95	
4.32.1	Ground clearance at lowest point	mm	30				
4.33	Aisle width for pallets 1000 x 1200 sideways	Ast mm	2737 ¹⁾	2750 ¹⁾	2921 ¹⁾	2854 ¹⁾	
4.34	Aisle width for pallets 800 x 1200 lengthways	Ast mm	2790 ¹⁾	2794 ¹⁾	2969 ¹⁾	2883 ¹⁾	
4.35	Turning radius	W _a mm	1663	1710	1865	1865	
4.37	length over the support arms	l ₇ mm	1842	1920	2075	2075	
Performance data	5.1	Travel speed, w. / w.o. load	km/h	14 / 14 ⁵⁾	14 / 14 ⁵⁾	14 / 14	14 / 14
	5.2	Lift speed, w. / w.o. load	m/s	0.38 / 0.64 ⁶⁾	0.38 / 0.64 ⁶⁾	0.35 / 0.64	0.35 / 0.64
	5.3	Lower speed, w. / w.o. load	m/s	0.55 / 0.55			
	5.4	Traverse speed w. / w.o. load	m/s	0.2 / 0.2 ⁶⁾	0.2 / 0.2 ⁶⁾	0.2 / 0.2	0.2 / 0.2
	5.7	Gradeability laden/unladen	%	7 / 11			
	5.8	Max. gradeability, laden/unladen	%	9 / 13	10 / 15	10 / 15	10 / 15
5.9	Acceleration time w. / w.o. load	S	4.6 / 4.2 ⁵⁾	4.6 / 4.2 ⁵⁾	5.4 / 4.8	5.4 / 4.8	
5.10	Service brake	electric					
Electrics	6.1	Drive motor rating S2 60 min.	kW	6.9 ⁵⁾	6.9 ⁵⁾	6.9	6.9
	6.2	Lift motor rating at S3 15%	kW	14.0 ⁶⁾	14.0 ⁶⁾	14.0	14.0
	6.3	Battery according to DIN 43531/35/36 A,B,C, no		DIN 43531 - C	DIN 43531 - C	DIN 43531 - B	DIN 43531 - C
	6.4	Battery voltage/nominal capacity K5	V/Ah	48 / 620 ³⁾	48 / 620	48 / 775	48 / 620
	6.5	Battery weight	kg	1005	1005	1210	1005
	6.6	Energy consumption according to VDI cycle	kWh/h	4.3 ⁴⁾	4.5 ⁴⁾	4.9	4.9
	6.7	Throughput efficiency	t/h	72.8 ⁴⁾	85.4 ⁴⁾	99.2	99.2
	6.8	Energy consumption at max. throughput	kWh/h	4.1 ⁴⁾	4.15 ⁴⁾	4.3	4.3
Misc.	8.1	Type of drive control	Mosfet / AC				
	8.2	working pressure for attachments	bar	150			
	8.3	oil flow for attachments	l/min	20			
	8.4	Sound pressure level at operator's ear according to EN 12053	dB (A)	68			

¹⁾ different battery sizes change these values

²⁾ mast-dependent

³⁾ Maximum battery size 775 Ah

⁴⁾ With Drive & Lift Plus options package

⁵⁾ With Drive Plus options package

⁶⁾ With Lift Plus options package

⁷⁾ With load wheel cover: + 30 mm

Benefit from the advantages



Ergonomic cab



SOLO-PILOT



Wide variety of options packages



Clear view through panoramic roof

Ergonomic cockpit

The operator position provides ideal working conditions for relaxed performance.

- Panoramic overhead guard for an unobstructed view of the raised load (optional).
- Fabric seat with adjustment options for seating position, backrest and body weight.
- Plenty of storage options.
- Important truck controls are within easy reach.
- Generous space, even for tall operators.
- Electric steering (choose 180° or 360°). When driving in a straight line, the steering wheel spinner knob is always at the optimum ergonomic position.
- Pedals configured in the same way as for a car. Automotive pedal configuration.

SOLO-PILOT control lever

Control lever for activating all hydraulic functions and the horn and for selecting the travel direction.

- All the controls are within the operators field of vision and are clearly designated for each specific function.

- Travel direction switch features intuitive direction change.
- Sensitive control of all functions for operating accuracy within millimetres.
- Extra attachments such as a fork positioner (optional) are also conveniently controlled by the SOLO-PILOT.

Easy-to-read operator display

High-quality control instrument displaying the most important operating data.

- Display of direction of travel and wheel position.
- Battery status with display of time remaining until the next charging.
- A choice of three travel programs for individual adaptation to any needs.
- Operating hours and time of day.
- Lift height (optional).
- Load weight (optional).
- Residual capacity (optional).

High-performance mast

Jungheinrich masts guarantee maximum safety and space utilisation to high lift heights.

- Triplex masts with lifting heights up to 13,000 mm.
- Excellent visibility to the load.
- Lowest clearances at high lift heights.

- High residual capacities even at high lift heights.
- Optional mast reach cushioning.

Optional packages for different conditions of use

- "Efficiency" for longest uptime with a battery.
- "Drive Plus" for applications with frequent long routes.
- "Lift Plus" for extensive lifting to high lift heights.
- Holder for radio data terminal, writing pad or video monitor.

Assistance systems (optional)

- Operation Control, the load weight is sequentially measured and compared with the residual capacity of the truck. If the limit value is approached, a visual and acoustic warning is issued.
- Position Control with SNAP function for a simple and fast stacking without additional pressing of keys.
- Warehouse Control stacking orders are automatically transferred by the warehouse management system. This prevents stacking in incorrect locations.
- Anti-slip Control for more traction on wet or dusty floors.

Jungheinrich UK Ltd.

Head Office:
 Sherbourne House
 Sherbourne Drive
 Tilbrook
 Milton Keynes MK7 8HX
 Telephone 01908 363100
 Fax 01908 363180

info@jungheinrich.co.uk
 www.jungheinrich.co.uk

The German production facilities in Norderstedt and Moosburg are certified. **ISO 9001**
ISO 14001

Jungheinrich fork lift trucks meet European safety requirements.



JUNGHEINRICH
 Machines. Ideas. Solutions.