

SECTION DRAWING

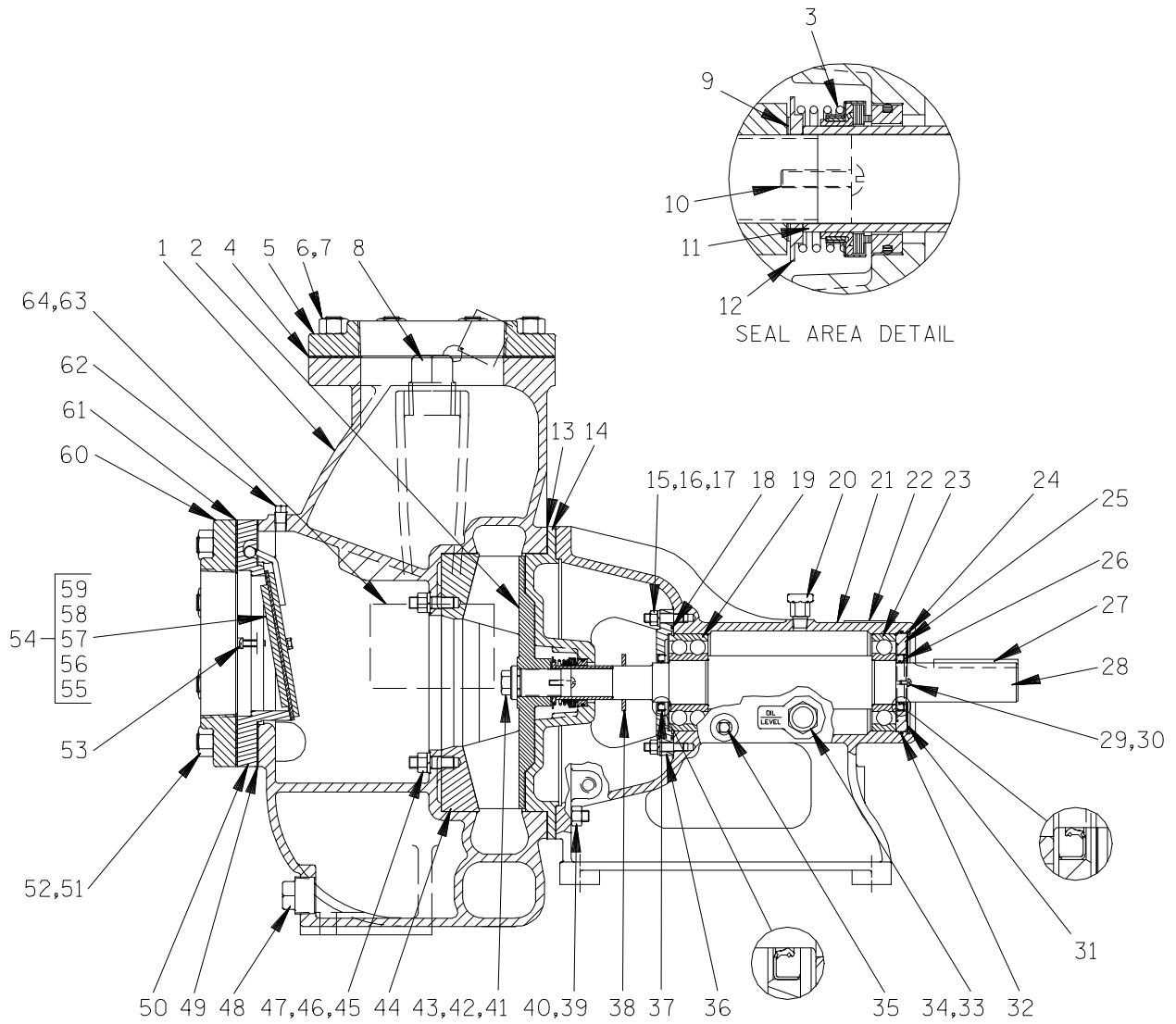

Figure 1. Pump Model 86B3-B

PARTS LIST
Pump Model 86B3-B
 (From S/N 819132 Up)

If your pump serial number is followed by an "N", your pump is **NOT** a standard production model. Contact the Gorman-Rupp Company to verify part numbers.

ITEM NO.	PART NAME	PART NUMBER	MAT'L CODE	QTY	ITEM NO.	PART NAME	PART NUMBER	MAT'L CODE	QTY
1	PUMP CASING	7267	10010	1	38	SLINGER RING	2352	19120	1
2 *	IMPELLER	7268	10010	1	39	STUD	C0810	15991	8
3 *	SEAL ASSY	25271-903	----	1	40	HEX NUT	D08	15991	8
4 *	DISCH FLANGE GASKET	1679GC	20000	1	41 *	IMPELLER CAPSCREW	B1004S	15991	1
5	DISCHARGE FLANGE	1758	10010	1	42 *	T-TYPE LOCKWASHER	21175-639	----	1
6	STUD	C1211	15991	8	43 *	IMPELLER WASHER	3039B	15990	1
7	HEX NUT	D12	15991	8	44	WEAR PLATE	7269A	10010	1
8	FILL PLUG ASSY	48271-068	----	1	45	STUD	C0808	15991	2
9	IMP ADJ SHIM SET	37J	17090	REF	46	HEX NUT	D08	15991	2
10	RD HD MACH SCREW	X0404	17090	2	47	LOCK WASHER	J08	15991	2
11 *	SHAFT SLEEVE	4523	16000	1	48	CASING DRAIN PLUG	P20	10009	1
12 *	SPRING WASHER	2889A	15990	1	49 *	VALVE SEAT GASKET	7261GA	20000	1
13 *	CASING GASKET SET	34GD	20000	1	50	CHECK VALVE SEAT	7261	10010	1
14	SEAL PLATE	3606	10010	1	51	STUD	C1215	15991	8
15	STUD	C0607	15991	6	52	HEX NUT	D12	15991	8
16	HEX NUT	D06	15991	6	53	RD HD MACH SCREW	X0404	17090	2
17	LOCK WASHER	J06	15991	6	54	FLAP VALVE ASSY	7265	----	1
18 *	O-RING	25152-248	----	1	55	-HEX HD CAPSCREW	B0403	17000	2
19 *	OUTBOARD BALL BRG	S1030	----	1	56	-LOCK WASHER	J04	17090	2
20	AIR VENT	S1703	----	1	57	-VALVE WEIGHT	7262	24000	1
21	PEDESTAL	3020B	10010	1	58	-VALVE WEIGHT	7263	15990	1
22	ROTATION DECAL	2613M	----	1	59 *	-CHECK VALVE GASKET	7264	19070	1
23 *	INBOARD BALL BEARING	S1077	----	1	60	SUCTION FLANGE	1758	10010	1
24	RETAINING RING	S1165	----	1	61 *	SUCTION FLG GASKET	1679GC	20000	1
25	BEARING RETAINER	38322-522	26000	1	62	PIPE PLUG	P04	15079	1
26 *	OIL SEAL	25227-534	----	1	63	NAME PLATE	38818-022	13990	1
27 *	SHEAFT KEY	N0615	15990	1	64	DRIVE SCREW	BM*04-03	17000	4
28 *	IMPELLER SHAFT	38515-527	16040	1	NOT SHOWN:				
29	RD HD MACH SCREW	X#10-01-1/2S	15991	2		STRAINER	S2278	----	1
30	LOCKWASHER	J#10	15991	2		LUBE DECAL	38816-079	----	1
31	BEARING ADJ SHIMN SET	8546	15990	1		INSTRUCTION TAG	38817-011	----	1
32 *	O-RING	25152-245	----	1		INSTRUCTION TAG	38817-028	----	1
33	SIGHT GAUGE	S1471	----	1		SUCTION STICKER	6588AG	----	1
34	PIPE PLUG	P12	15079	1		PRIMING STICKER	6588AH	----	1
35	PEDESTAL DRAIN PLUG	P06	15079	1		DISCHARGE STICKER	6588BJ	----	1
36	BEARING CAP	38322-418	10010	1	OPTIONAL:				
37 *	OIL SEAL	25227-534	----	1		120V CASING HEATER	48711-028	----	1
						240V CASING HEATER	48711-029	----	1

* INDICATES PARTS RECOMMENDED FOR STOCK